

## Assembly Instructions

**READ THROUGH THESE INSTRUCTIONS PRIOR TO STARTING ASSEMBLY.**

### Document Instructions

Use Document #1016006 with fastener kits 879425 and 879426. These kits are to be used with the Vektor-MD model. The fasteners contained within the kit are to be used to attach the windband to the Vektor-MD nozzle. Use the images located within this document to locate the position of the fasteners on the unit.

**Note:**

**Vektor-MD – Sizes 36 and smaller, nozzle is attached to the fan housing.**

**Vektor-MD – Sizes 40 and greater, windband and nozzle ships as individual pieces.**

**Assembly Instructions**

1. See Greenheck Document #464652 (Installation, Operation and Maintenance Manual: Vektor-MD, Vektor-MH and Vektor-MS) for full installation instructions.
2. See image to the right to locate bolt holes. Attach windband using the provided moly-coated 316 stainless steel bolts through the bolt holes.

**Tools Required**

- Cordless drill (electric or pneumatic)
- 9/16 inch nut setter
- 9/16 inch wrench

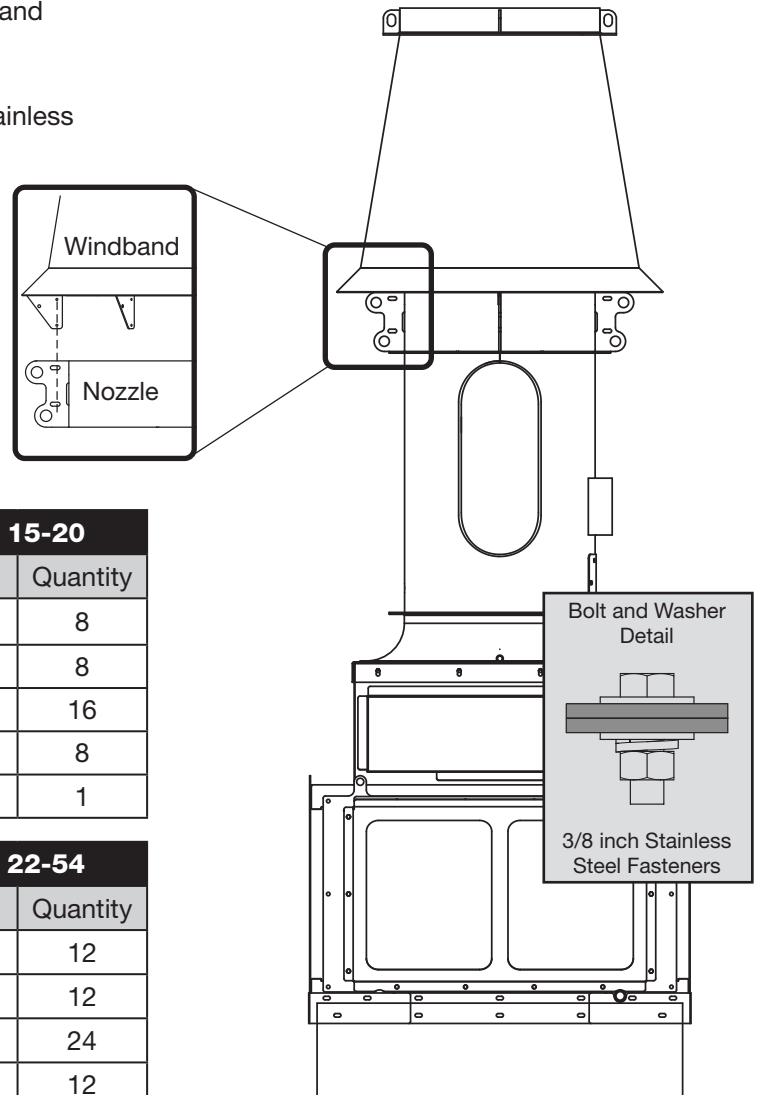

**FASTENER KIT 879425 – VEKTOR-MD SIZE 15-20**

Part Description	Part #	Quantity
CS,HH,.375-16X1.5,SS,316,MOLY	415781	8
NUT,HEX,.375-16,SS,316	415799	8
WSHR,FLAT,.313X.05X.406X.875,SS,316	415800	16
WSHR,LOCK,SPLIT,.375,SS,316	415810	8
Assembly Instructions	1016006	1

**FASTENER KIT 879426 – VEKTOR-MD SIZE 22-54**

Part Description	Part #	Quantity
CS,HH,.375-16X1.5,SS,316,MOLY	415781	12
NUT,HEX,.375-16,SS,316	415799	12
WSHR,FLAT,.313X.05X.406X.875,SS,316	415800	24
WSHR,LOCK,SPLIT,.375,SS,316	415810	12
Assembly Instructions	1016006	1