

## Assembly Instructions

**READ THROUGH THESE INSTRUCTIONS PRIOR TO STARTING ASSEMBLY.**

### Document Instructions

Use Document #1016722 with fastener kits 914746, 914747, 914748 and 914749. These kits are to be used with the Vektor-M series. The fasteners contained within the kit are to be used to join the bypass air plenum (BAP) to mating energy recovery plenum (ERS). Use the images located within this document to locate the position of the fasteners on the unit.

### Assembly Instructions

- See Greenheck Document #474118 (Installation, Operation and Maintenance Manual: Energy Recovery Laboratory Exhaust) for full installation instructions.
- The fastener kit includes fasteners to attach one BAP to the ERS plenum. If the fan array includes multiple BAP sections, multiple fastener kits will be supplied.
- See image on right to locate bolt holes. Install 316 stainless steel bolts with three washers from inside of the ERS plenum through the marriage wall into the threaded nut-inserts on mating wall of BAP.

### Tools Required

- Cordless drill with 1/2 inch nut setter or 1/2 inch wrench

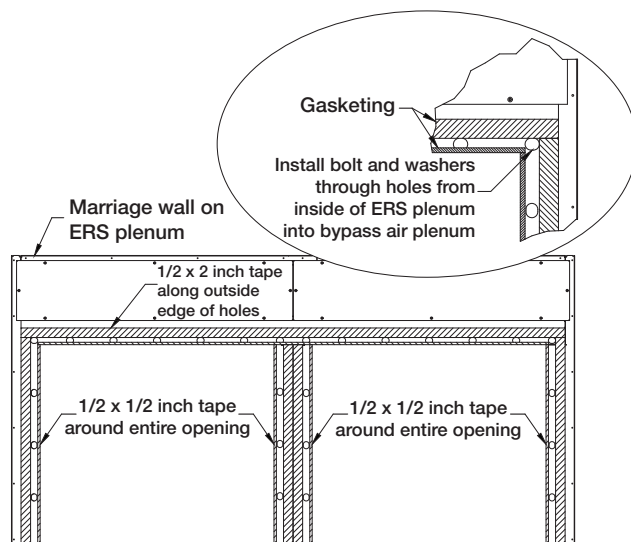
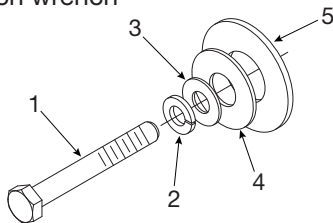

Plenum view from fan side

### NOTE

If gasketing on marriage wall is missing, consult factory before installing hardware.

BAP TO ERS PLENUM FASTENER KIT		MD2 914746	MD3/MD4 914747	MD5/MD6 914748	MD7 914749
Part Description	Part #	Quantities			
1 CS,HH,,313-18X2.5,SS,316	416866	11	13	15	21
2 WSHR,LOCK,,313,SS,316	415811	11	13	15	21
3 WSHR,FLAT,,313X.045X.34X.75,SS,316	415798	11	13	15	21
4 WSHR,FLAT,,5X.06X.531X1.25,SS,316	415803	11	13	15	21
5 WSHR,FLAT,,75X.1X.812X1.75,SS,316	415830	11	13	15	21
Assembly Instructions	1016722	1	1	1	1