

Kitchen Ventilation Systems Controls



BUILDING VALUE IN AIR.



October
2020

New Greenheck controls give you a simple, efficient way to operate and oversee your entire kitchen ventilation system. This control system features intuitive full-color touchscreen technology and simplified tool-free interface mounting with fewer parts and less wiring for easy installation and streamlined operation. Experience energy and cost savings as well as increased productivity from your staff by providing comfort throughout your operation.

Greenheck understands the importance of managing multiple connections between kitchen system components. With the Greenheck controls platform, you gain even more value from our complete kitchen ventilation solution. Trust Greenheck to deliver the same quality and clarity our products are known for, plus continued innovation to help your operation thrive.

The Greenheck Advantage

- ✓ Plug-and-play connections, fewer managed parts and clearly labeled field wiring diagrams for easy installation, saving you time and money. Highly customizable to meet any kitchen ventilation need.
- ✓ Easy to troubleshoot with more turnkey components built in for added efficiency, trouble-free access to more diagnostics, and less factory wiring for worry-free maintenance.
- ✓ Full-color, intuitive user-friendly touchscreen for a clearer and brighter interface over standard black-and-white bitmap screens making it easier to see, read and control.
- ✓ Each control is tested thoroughly before it leaves the factory, giving you complete confidence in best-in-class product quality with the peace of mind you've come to expect from Greenheck.
- ✓ Seamless design eliminates unsightly fasteners and buttons that can lead to grease buildup and require extra cleaning. Features tool-free interface mounting for easy install and a modern, sleek look.



The bright interface with an easy to understand intuitive touchscreen allows for easy navigation through the operation and configuration screens.

The interface can be programmed to allow you to see and control only functions you select without requiring you to go through a series of screens not applicable to your needs — a truly innovative solution, simplifying the control of your total kitchen ventilation system.



Common Display Screens

The user-friendly touch screen features easy-to-read instructions for simple, concise operation. Every screen lets you easily navigate throughout the interface without confusion. The following are typical screens.



Simple navigation and clear, straightforward graphics help you take control at the touch of a button. Innovative technology allows you to toggle the touch screen on and off with ease. This screen is the most common screen an operator will have access to during use.

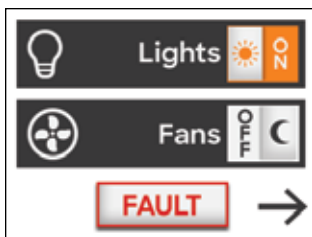

If a complication or error occurs in the kitchen ventilation system, a **FAULT** alert will appear on screen, immediately notifying your staff of a problem.

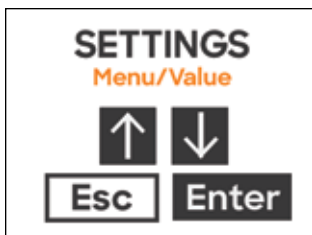

Conveniently troubleshoot directly from the touch screen without the need for a separate control board. For added security, the settings menu is password protected so only authorized users can access when needed.

Complete Control

Control your entire kitchen ventilation system with ease — from fans, make-up air and lighting to all components of a constant or variable volume ventilation system. The Greenheck controls platform provides increased value using high-quality products integrated seamlessly for a streamlined, efficient operation. New options such as a room thermostat allow you to customize your kitchen ventilation needs.

Improved Aesthetics

Tool-free interface mounting, push-to-fit assembly with no visible screws and the elimination of bulky, unattractive buttons alleviate the worry of added grease buildup that can occur and require extra labor to keep clean. The result is a contemporary, aesthetically pleasing, uniform design.

Streamlined Installation

Field wiring diagrams and clear labeling decals are mounted inside of the panel next to the wiring connection points to help guide and ease installation and start-up. With several plug-and-play connections, the system has fewer parts and wires to manage.

Enhanced Interface

A vibrant, full-color touch screen is easy to see, simple to understand and straightforward to operate. The integrated platform allows you to navigate effortlessly through the interface using the same steps for each system connected to the control unit. Control your entire commercial kitchen ventilation system with ease with the intuitive touch screen.

Advanced Engineering

The sophisticated control unit uses the latest in printed circuit board technology, engineered for convenient installation and efficient diagnostic purposes. Options that once would have required intricate wiring are now built into the compact printed circuit board software, removing complexity and utilizing less space within the unit.

Balancing Ease and Flexibility

Balance your fans easily. A single control unit can control up to eight fans for added efficiency and seamless connection throughout your commercial kitchen. Compatible with numerous fan control options, including motor starters, variable frequency drives, and high-efficiency Greenheck Vari-Green® motors.



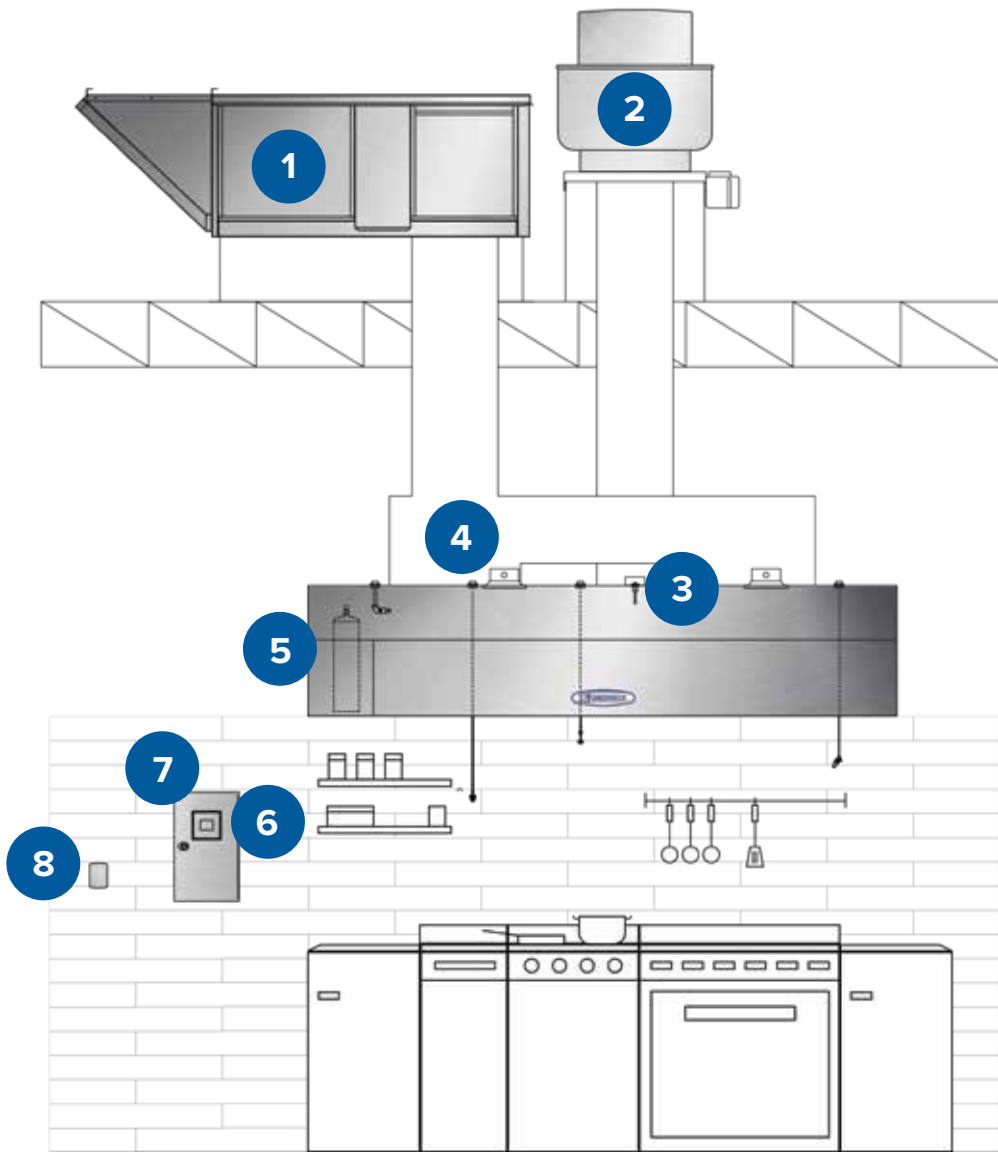

One System Under Your Control

- | | |
|-----------------------------|---------------------------------|
| 1 Make-Up Air | 5 Fire Suppression |
| 2 Exhaust Fan | 6 Touch Screen Interface |
| 3 Temperature Sensor | 7 Control Panel |
| 4 Lights | 8 Room Sensor |

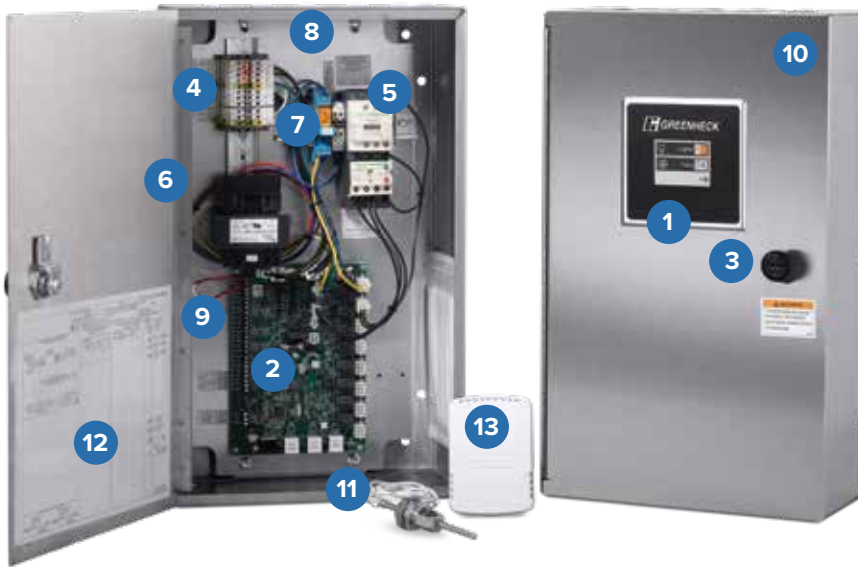

- 1 Touch screen interface (can be shipped mounted or loose)
- 2 Main control board
- 3 Quarter-turn latch
- 4 Terminal blocks for field connections
- 5 Motor starters/VFDs
- 6 Control transformer
- 7 Control relay
- 8 Field connection knockout holes
- 9 Low voltage field connections to circuit board
- 10 Control box (depends on configuration)
- 11 Temperature sensor
- 12 Clear installation labeling
- 13 Room sensor (optional)

Model Number Code

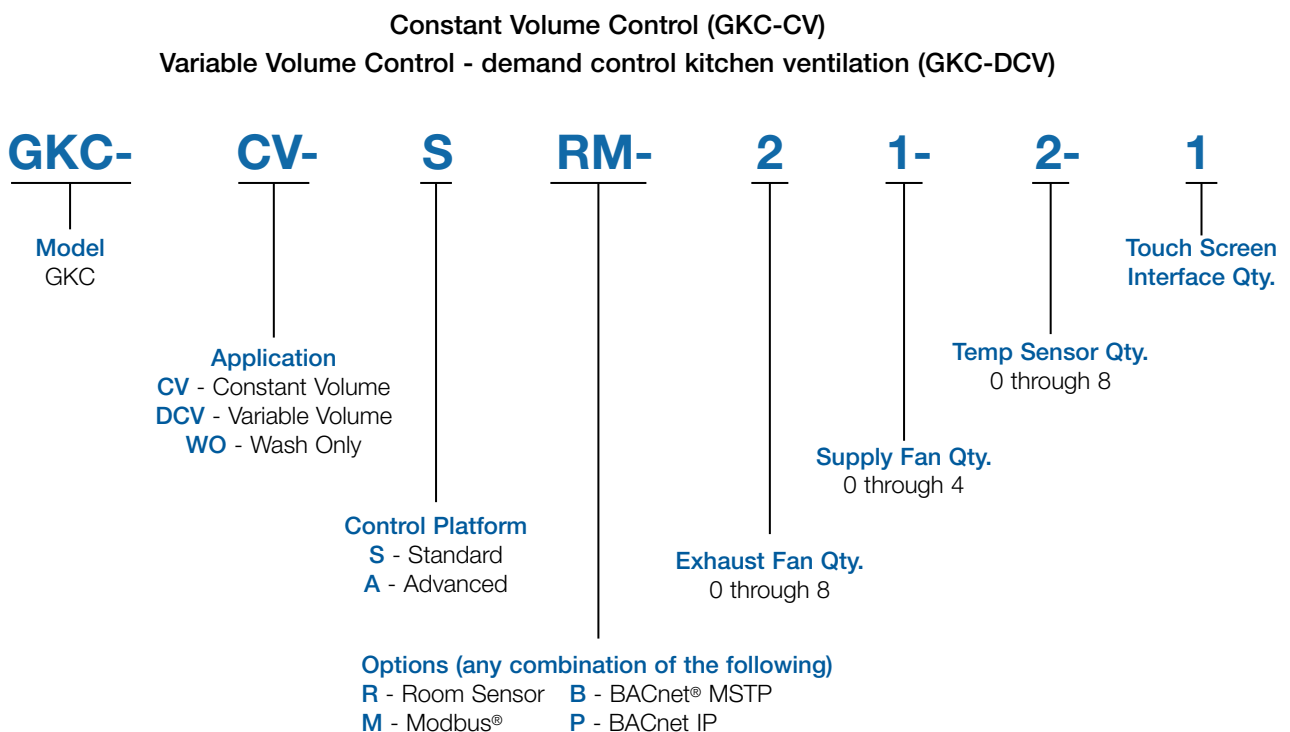

Energy and Cost Saving Variable Volume Control

Greenheck saves energy and money with industry-leading turndown capabilities, high-efficiency motors and heat sensors, and the quick response and convenience of our demand controlled kitchen ventilation (DCKV).

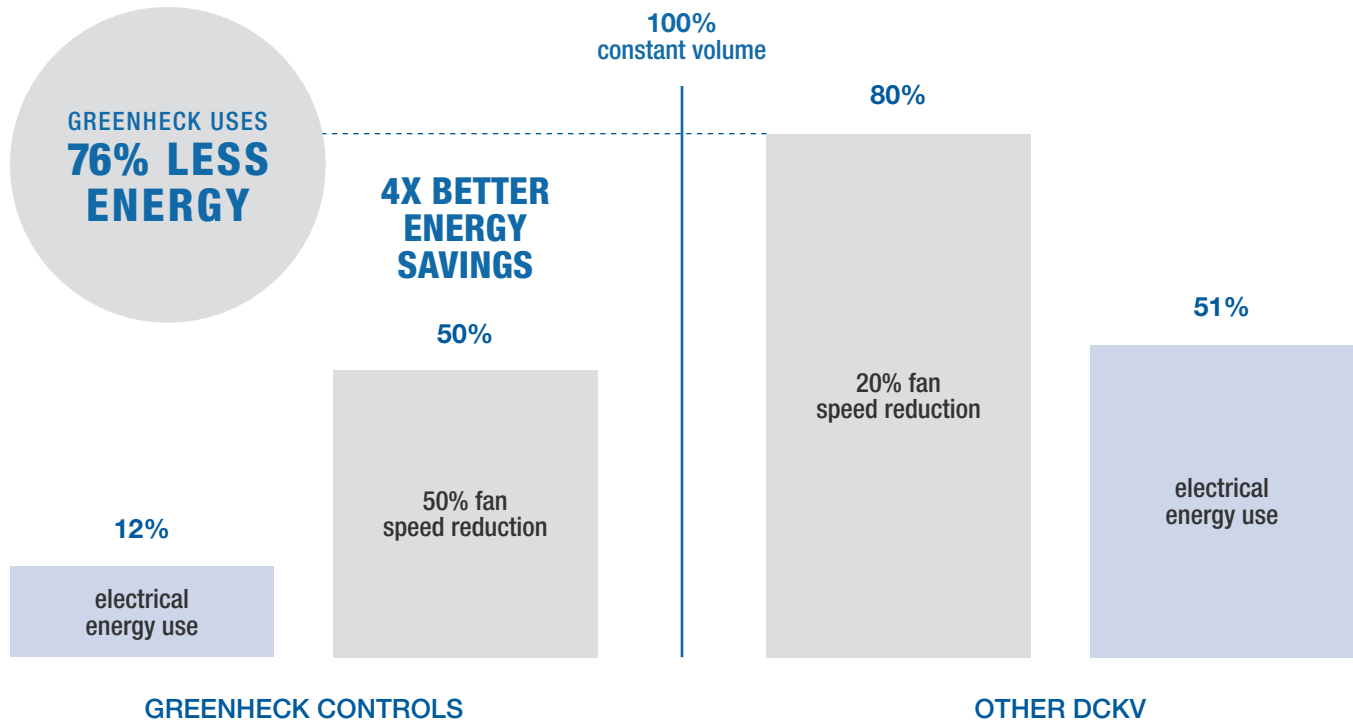

In conjunction with a Greenheck Vari-Green® motor and direct gas-fired make-up air units featuring our patented barometric bypass damper, our DCKV provides 50% airflow reduction leading to greater savings on gas and electric usage of the unit.

- Adjusts fan speeds by up to 50%, decreasing airflow when peak exhaust rates aren't necessary, resulting in electrical savings of up to 88%. The Greenheck GKC-DCV monitors cooking temperatures and adjusts exhaust and supply fan speeds. Fans operate at a reduced volume, saving energy when the cooking load reduces.
- Hood-mounted temperature sensors respond to temperature changes up to five times faster than duct-mounted sensors, resulting in quicker airflow modulation and more efficient control and operation.
- Decreased fan usage results in less wear on the motor, belts and pulleys — reducing maintenance.
- Extends the lifespan of your fans, providing more time to reduce costs and realize return on investment. The typical payback is one to three years.
- Fan speeds automatically adjust and save energy based on temperature changes under the hood. A heated or cooled make-up air unit allows you to benefit from reduced gas and electric consumption.

[Learn more at Greenheck.com](https://www.greenheck.com)

Constant Volume Ventilation: Complete Safety and Total Control

Code-compliant back-up safety controls automatically activate the exhaust system when cooking appliances begin generating heat and keep fans running until temperature drops.

Override manual controls safely and easily with automatic fan activation that connects all fans in the same zone.

Enjoy Greenheck's extraordinary service, before, during and after the sale.

Greenheck offers added value to our wide selection of top performing, energy-efficient products by providing several unique service programs.



Our Quick Delivery program ensures shipment of in-stock products within 24 hours of placing your order. Our Quick Build made-to-order products are manufactured in 1-3-5-10-15 or 25-day production cycles, depending upon its complexity.



Greenheck's free computer aided product selection program CAPS®, rated by many as the best in the industry, helps you conveniently and efficiently select the right products for the challenge at hand.



Our 3D service allows you to download, at no charge, easy-to-use AutoDesk® Revit® 3D drawings for many of our ventilation products.

Find out more about these special services at greenheck.com



Building Value in Air

Greenheck delivers value to mechanical engineers by helping them solve virtually any air quality challenges their clients face with a comprehensive selection of

top quality, innovative air-related equipment. We offer extra value to contractors by providing easy-to-install, competitively priced, reliable products that arrive on time.

And building owners and occupants value the energy efficiency, low maintenance and quiet dependable operation they experience long after the construction project ends.

Our Commitment

As a result of our commitment to continuous improvement, Greenheck reserves the right to change specifications without notice.

Specific Greenheck product warranties are located on greenheck.com within the product area tabs and in the Library under Warranties.

