

Model: HLC-FFR-SS-1

Stainless Steel Face and Backpan - Flush Surface Mount

HLC-FFR-SS-1 - Flush Surface Mount

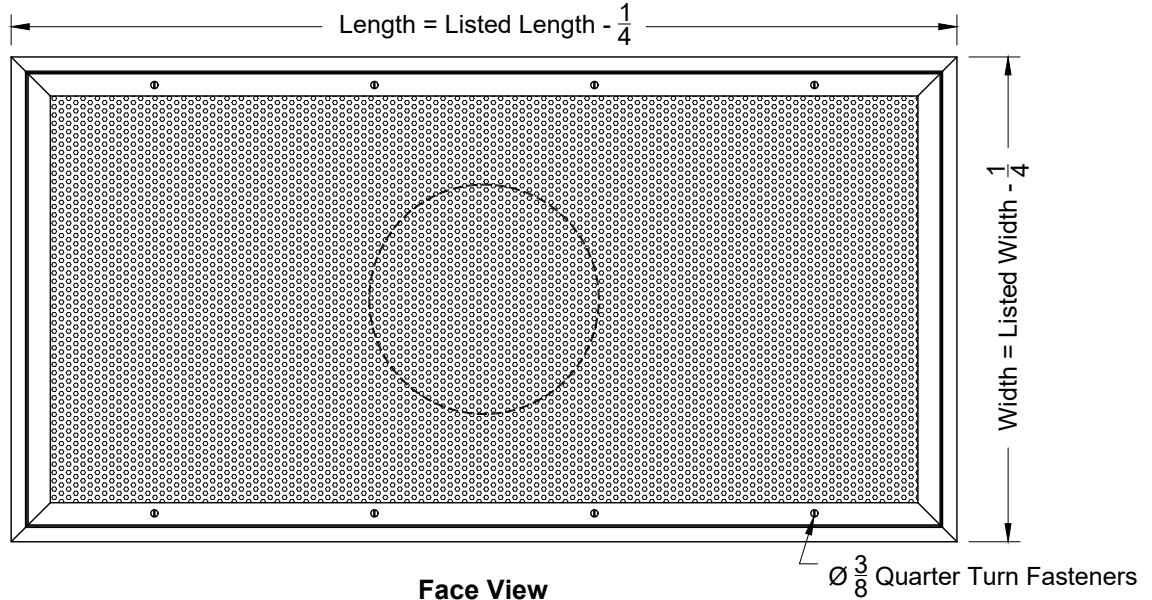

Face View

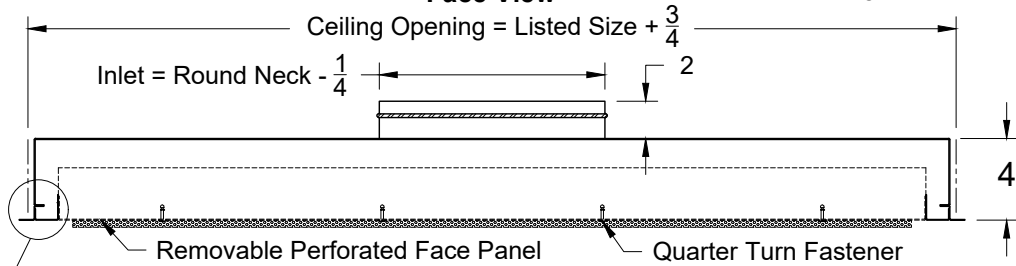

Side View

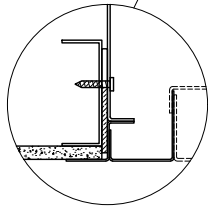

Steel Channel

Blocking & Fastening by Others.
Use Shims To Center Diffuser In
Opening Against Blocking.

Side View 1 Way Airflow

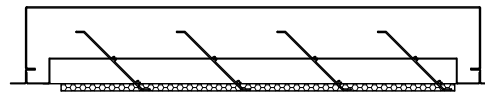

Side View 2 Way Airflow

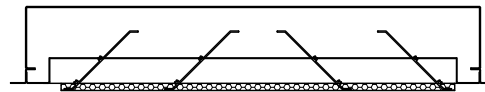

| Available Sizes | | | |
|-----------------|----|----|----|
| Widths | 12 | 24 | - |
| Lengths | - | 24 | 48 |

| Available Round Neck Sizes | | | | | |
|----------------------------|---|---|----|----|----|
| Neck | 6 | 8 | 10 | 12 | 14 |

| 1. Available Finishes | 2. Available Accessories | 3. Available Options | 4. Construction Details |
|--|--|-------------------------------|---|
| Standard Finish: 24 Mill Finish Optional Finish: 01SS White | XG-BDS-SS - Stainless Butterfly Damper XG-TBPFSS - Stainless Steel TBPF | EI - External 1/2" Insulation | <ul style="list-style-type: none"> Fully welded Seams and Frame Perforated Panel Free Areas: 16%, 23% and 51% Available Available with 1 Way or 2 Way Air Flow Stainless Steel Construction |

All Dimensions $\pm 1/16"$

Model: HLC-FFR-SS-6

Stainless Face and Backpan - T-Bar Lay In

HLC-FFR-SS-6 - T-Bar Lay In

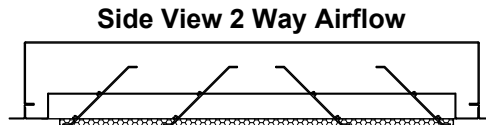
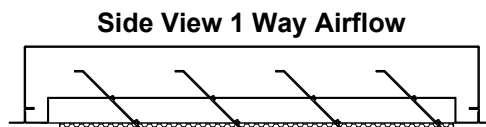
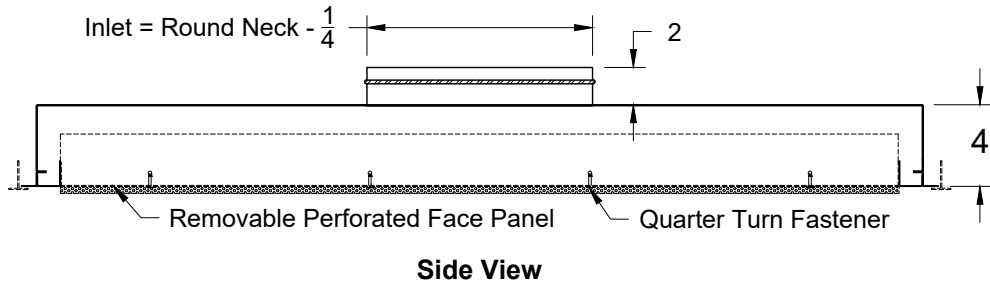
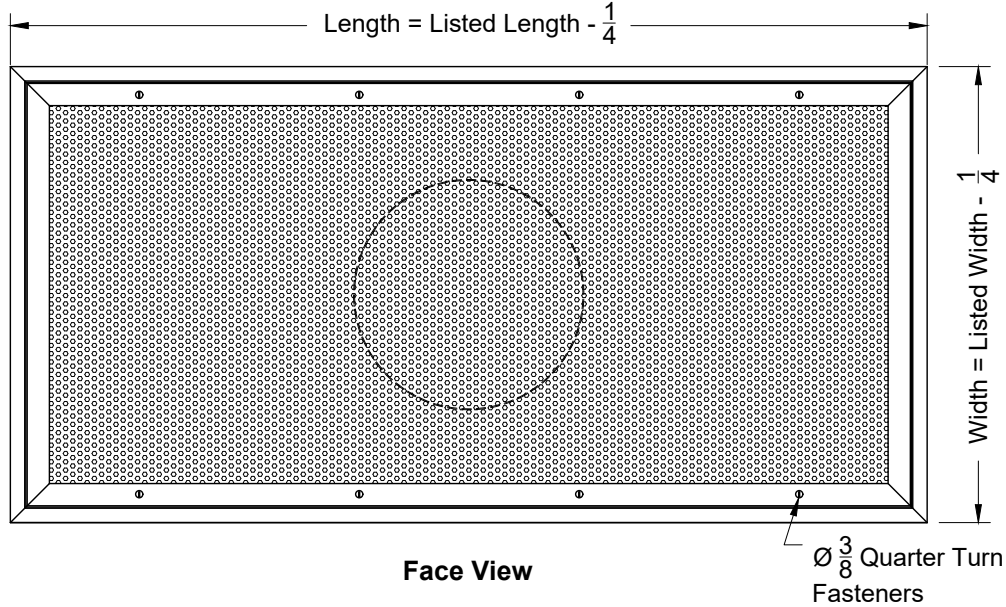

| Available Sizes | | | |
|-----------------|----|----|----|
| Widths | 12 | 24 | - |
| Lengths | - | 24 | 48 |

| Available Round Neck Sizes | | | | | |
|----------------------------|---|---|----|----|----|
| Neck | 6 | 8 | 10 | 12 | 14 |

| 1. Available Finishes | 2. Available Accessories | 3. Available Options | 4. Construction Details |
|--|--|-------------------------------|---|
| Standard Finish: 24 Mill Finish Optional Finish: 01SS White | XG-BDS-SS - Stainless Butterfly Damper XG-TBPFSS - Stainless Steel TBPF | EI - External 1/2" Insulation | <ul style="list-style-type: none"> Fully welded Seams and Frame Perforated Panel Free Areas: 16%, 23% and 51% Available Available with 1 Way or 2 Way Air Flow Stainless Steel Construction |

All Dimensions ±1/16"