

Installation, Operation and Maintenance Manual

Please read and save these instructions for future reference. Read carefully before attempting to assemble, install, operate or maintain the product described. Protect yourself and others by observing all safety information. Failure to comply with these instructions will result in voiding of the product warranty and may result in personal injury and/or property damage.

Powerpack Replacement Installation

The following instructions describe the procedure to replace a powerpack on a centrifugal upblast fan.

1. Turn off power and lock out power supply.
2. Remove hood to gain access to motor compartment by pushing in two adjacent snap buttons and lifting. Figure 1.
3. Disconnect external power coming into the junction box, as well as any electrical conduit (if present). Disconnect any controls wiring (if present). Figure 2.
4. Remove the 4 or 6 screws which secure the powerpack in place using a 7/16" hex driver.
5. Note the powerpack orientation before removal. While keeping the powerpack assembly centered in the housing, carefully remove it. Ensure that the wheel doesn't catch on the hoodband or damage the housing upon removal.

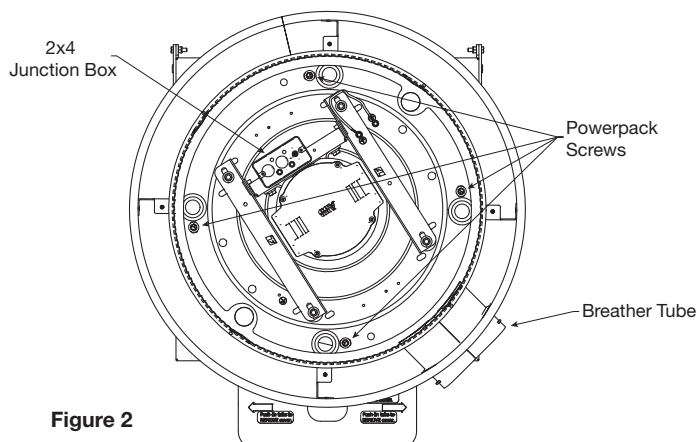
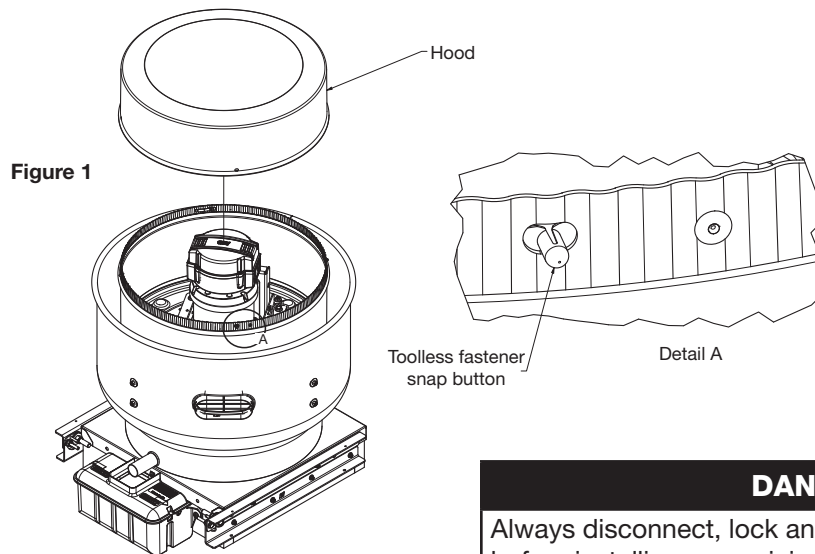

DANGER

Always disconnect, lock and tag out power source before installing or servicing. Failure to disconnect power source can result in fire, shock or serious injury.

CAUTION

When servicing the fan, motor may be hot enough to cause pain or injury. Allow motor to cool before servicing.

DANGER

Pour écarter les risques d'incendie, de choc électrique ou de blessure grave, veiller à toujours débrancher, verrouiller et étiqueter la source de courant avant l'installation ou l'entretien.

ATTENTION

Lors de toute intervention sur la soufflante, le moteur peut être suffisamment chaud pour provoquer une douleur voire une blessure. Laisser le moteur refroidir avant toute maintenance.

6. Transfer accessories not included with the new powerpack from the original. This may include disconnect switches, controls, etc.
7. On powerpacks with a composite wheel, check if a baffle is installed on the powerpack that was removed. If baffle is present on existing wheel, install the loose snap fit baffle onto new powerpack to match. Figure 3.
8. Pick up the new powerpack and place into the housing in the same orientation as the previous one. Figure 4.

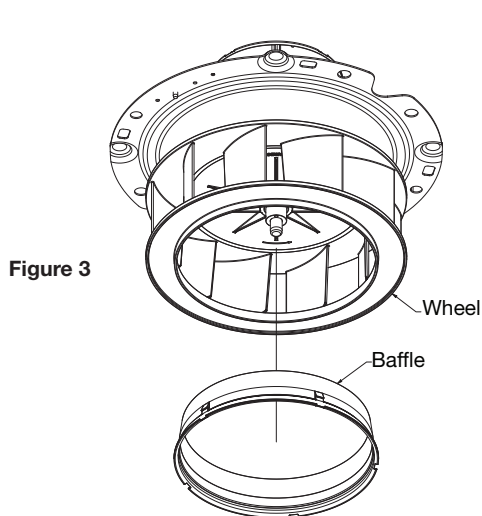

Figure 3

Baffle install only applies to fan sizes 60 and 80. See step 7.

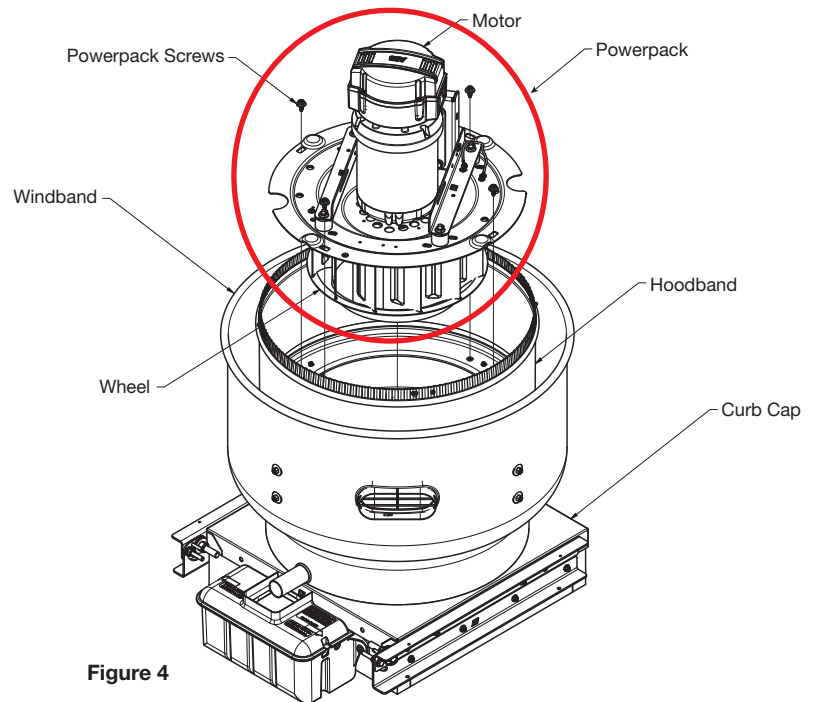

Figure 4

9. Install powerpack screws but do not fully tighten. Spin the fan wheel by hand to check for wheel rub. If rubbing occurs, adjust location of powerpack within the housing until rubbing is no longer present. Tighten screws to 9 ft-lbs. See Figures 5 and 6 for recommended clearance between the fan wheel and inlet venturi.

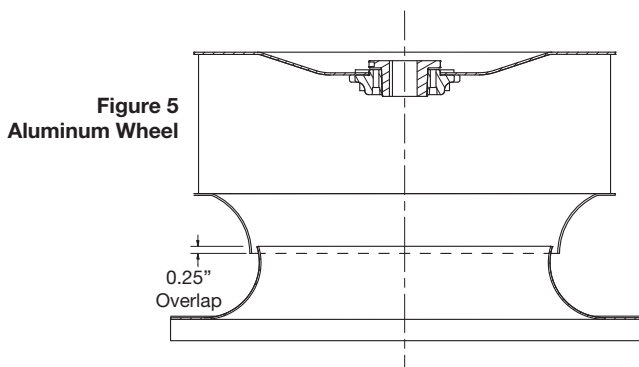

Figure 5
Aluminum Wheel

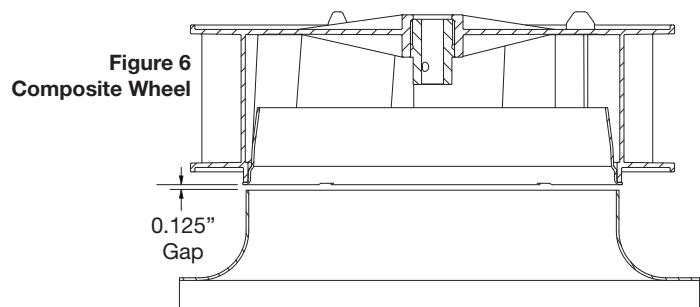

Figure 6
Composite Wheel

10. Reconnect any wiring that was disconnected in step 3.
11. Turn on power to the fan. If no issues are detected, re-install the hood.

NOTE

This powerpack is only compatible with units manufactured from 2025 onwards. The presence of snap buttons will indicate the fan is compatible with the replacement powerpacks. Guarantee the replacement is the correct size (e.g. "-140") by comparing the fan's nameplate to the label on the powerpack box.

NOTE

Sizes greater than 200 not to be mounted in a sidewall orientation.