

## Reference Guide for Direct Drive Weatherhood Assembly

Please read and save these instructions for future reference. Read carefully before attempting to assemble, install, operate or maintain the product described. Protect yourself and others by observing all safety information. Failure to comply with these instructions will result in voiding of the product warranty and may result in personal injury and/or property damage.

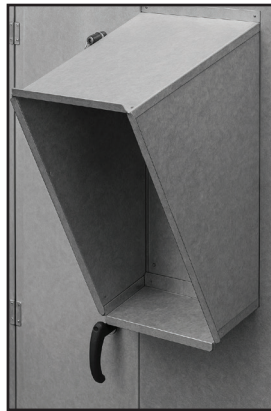

ERV Technical Support  
 Call 1-800-240-0870

### Direct Drive Weatherhood Assembly Instructions

Unpack, inspect, and verify receipt of the correct weatherhood pieces for your unit. The exhaust weatherhood provided with your energy recovery unit is based on the unit size.

To determine the weatherhood you have received, examine the nameplate to figure out the unit size.

Then refer to the Weatherhood Parts List table below. Locate the Unit Model and compare the parts listed with the weatherhood you have received.

Once the parts are verified, continue with the weatherhood assembly procedures on Page 2.

Weatherhood Parts List			Unit Model			
Part Description	Qty		ERVe-20	ERVe-35	ERVe-45	ERVe-55
			Part #*	Part #*	Part #*	Part #*
Item 1	Weatherhood Right Side	1	784322	784676	784668	784663
Item 2	Weatherhood Left Side	1	784324	784675	784669	784660
Item 3	Weatherhood Top	1	784323	784674	784667	784661
Item 4	Weatherhood Bottom	1	784326	784673	784665	784659
Item 5	Weatherhood Assembly	1	-	-	-	-
Item 6	Lower Damper Assembly	1	-	-	-	-
Item 7	Birdscreen Assembly	1	330743	330744	330745	330746

\*Part numbers are for non-painted units. Consult factory for replacement parts on painted units.

Hardware Kit Part Number 852259		
Part Description	Qty	Part #
Screws, SMS (A) 12 x 5/8 (IHH)	34	415180
Assembly Instructions	1	487930

Tools Required
<ul style="list-style-type: none"> <li>• Cordless drill (electric or pneumatic)</li> <li>• 5/16 inch nut setter</li> </ul>

## Assembly Instructions

Assembly Instructions The following steps explain how to assemble and attach the exhaust weatherhood to the energy recovery unit. Prepunched holes and sheet metal screws are provided for your convenience.

1. Remove cover from Exhaust Discharge Opening
2. Attach weatherhood sides (Items 1 and 2) to energy recovery unit.
3. Attach bottom (Item 4).
4. Secure the Upper Damper Assembly (Item 5) to the unit.
5. Lift the damper and install the birdscreen (Item 7) in the opening of the outlet.
6. Secure the Lower Damper Assembly (Item 6) to the unit.
7. Attach the top (Item 3)
8. Caulk the unit/weatherhood seams on the top, bottom and sides.

After completing these steps, check to make sure the damper blades (Item 5 and Item 6) seals against the magnetic strips on the weatherhood sides (Items 1 and 2) and along the bottom (Item 4). Adjust as necessary.

Contact your local representative if replacement parts are required.

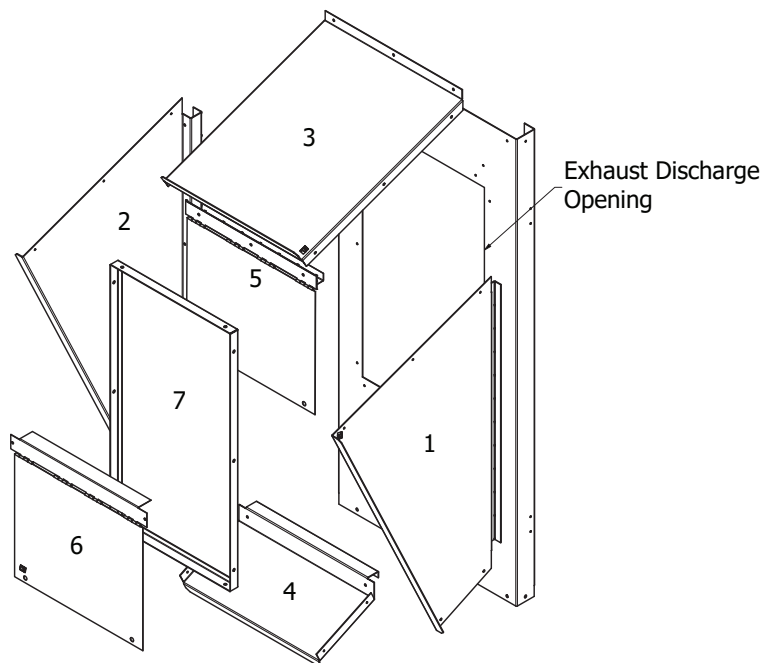

## Our Commitment

*As a result of our commitment to continuous improvement, Greenheck reserves the right to change specifications without notice.*

Specific Greenheck product warranties are located on [greenheck.com](http://greenheck.com) within the product area tabs and in the Library under Warranties.

AMCA Publication 410-96, Safety Practices for Users and Installers of Industrial and Commercial Fans, provides additional safety information. This publication can be obtained from AMCA International, Inc. at [www.amca.org](http://www.amca.org).

